



## ELECTRICAL/MECHANICAL DATA

<b>Model</b>	50 75 100 130 150 175 200 225 250 300 350 360 400 450 500 550 600 650 700 750 800 850 900 950 1000 1100 1200 1250 1300 1400 1500
Electrical stroke (C.E.)	mm <b>Model</b>
Independent linearity	± %F.S. typical 0,02 (Max. 0,04)
Max. dimensions (A)	mm <b>Model + 154</b>
Repeatability	mm < 0,01
Hysteresis	mm < 0,01

## ELECTRICAL CONNECTIONS

**OUTPUT MK4C A**

**OUTPUT MK4C B**

**OUTPUT MK4C F**

Function	Connect. (B) Pin°	Connect. (A) Pin°	Cable (Wire Color)
CAN L	1	5	Blue
CAN H	2	4	White
n.c.	3	1	-
n.c.	4	-	-
Power + Vdc	5	2	Red
DC Ground	6	3	Black

**ATTENTION!** Do not connect the DC Ground to the ground or to the cable sheathing.

## ORDER CODE

Position transducer **MK4** **C**

CANopen interface	<b>C</b>
6-pin DIN 45322 output connector	<b>B</b>
5-pin Micro type M12 output connector	<b>A</b>
4-pin braided cable (on request)	<b>F</b>

**Model**

Type (see table 1)

Transmission speed (see table 2)

Type	N° Cursors	PD01 (Standard)	PD02 (Standard)
<b>A</b>	1	Position 4 Byte whole Speed 2 Byte whole Cams 1 Byte whole	Absence of data
<b>B</b>	2	Position 1, 4 Byte whole Speed 2 Byte whole Cams 1 Byte whole	Position 2, 4 Byte whole Speed 2 Byte whole Cams 1 Byte whole

1 = 1MBaud	4 = 250 kBaud	7 = 50 kBaud
2 = 800 kBaud	5 = 125 kBaud	8 = 20 kBaud
3 = 500 kBaud	6 = 100 kBaud	9 = 10 kBaud

Mechanical and/or electrical characteristics differing from those in the standard version may be arranged on request

Ex.: **MK4-C-B-0400-A-3 0000-2-XXXX-00-X-0-XX**  
 Transducer model MK4, CANOpen output, connector B, model 400, type A (one cursor), transmission speed 500 Kbaud

## CODE EXTENSION

**0 0 0 0**  **X X X X**   **X 0 X X**

**System resolution**  
 1 = 0.002 mm  
 2 = 0.005 mm (standard)  
 3 = 0.010 mm  
 4 = 0.020 mm  
 5 = 0.040 mm

**Node number programmer**  
 XXX = standard; node = 127  
 nnn = Node number specified in order

**Cable length**  
 Output **F 00** = 1mt **02** = 2mt **03** = 3mt **04** = 4mt **05** = 5mt  
 Output **B 00** **06** = 6mt  
 Output **M 00**

**Termination load**  
**0** = without termination load  
**1** = 120Ω termination load

## Transmission speed as function of cable length

Cable length	Baud Rate (KBaud)	Cable length	Baud Rate (KBaud)
< 25 m	1000	< 500 m	125
< 50 m	800	< 1000 m	100
< 100 m	500	< 1250 m	50
< 250 m	250	< 2500 m	20 / 10

## Can Open Data Protocol

SOFF	Arbitration	Control	Data Field	CRC	ACK	EOF	Interframe Space
1	11	1	6	0 - 8 Bytes	15	1   1   1	7
							≥ 3 Bits

## CURSORS ON REQUEST

P C U R

Cursors	
Sliding cursor , axial joint (low) (STANDARD)	035
Sliding cursor , axial joint (high)	036
Sliding cursor , angled joint	037
Floating cursor	034

PCUR035

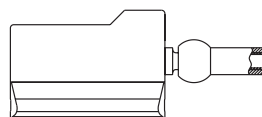

PCUR036

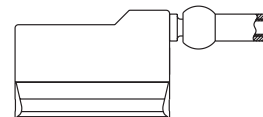

PCUR037

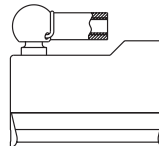

PCUR034

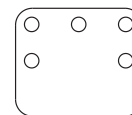

## BRACKET S ON REQUEST



P K I T

Brackets (2 brackets for every kit)	
Bracket in steel, interaxis 42.5mm	090
Bracket in steel, interaxis 50mm	091

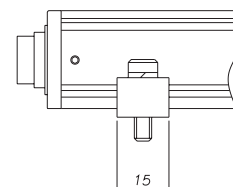
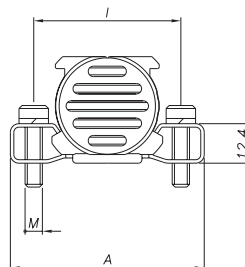

Brackets code	Interaxis (i)	Screw (V)	Dimension (A)
PKIT090	42.5	M4	56
PKIT091	50	M5	63.5

## OPTIONAL FEMALE CONNECTORS

For A outputs, M12 thread connector

Codes: **CON031** for 5-pin output (MK4C A)  
**CON041** for 5-pin output (MK4C A)

For B outputs, M16 thread connector

Codes: **CON021** for 6-pin output (MK4C B)  
**CON022** for 6-pin output (MK4C B)  
**CON023** for 6-pin output (MK4C B)

Connector extraction length: 10mm

Cable camp for ø6.5 cable

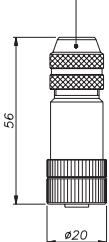

CON031  
IP67 - IEC 48B

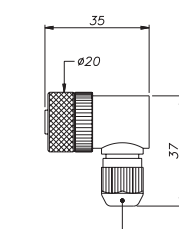

Cable camp for ø6 - ø8 cable

CON041  
IP67

Cable camp for ø5 cable

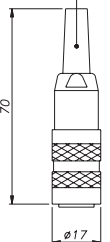

CON021  
IP40 - EMC

Cable camp for ø6 - ø8 cable

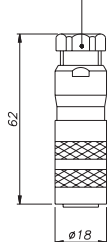

CON022  
IP67 - EMC

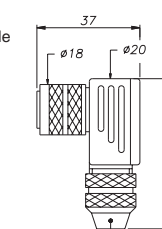

Cable camp for ø5 - ø8 cable

CON023  
IP67 - EMC

## OPTIONAL CABLES OUTPUT A

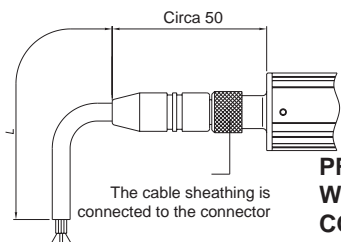

**PRE-ASSEMBLED CABLE WITH STRAIGHT CONNECTOR**

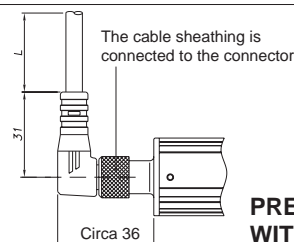

**PRE-ASSEMBLED CABLE WITH 90° CONNECTOR**

5-pin cable code		MK4C - A	
Lenght "L"		CODE	
		straight cable	Cable to 90°
2	mt	CAV011	CAV021
5	mt	CAV012	CAV022
10	mt	CAV013	CAV023
15	mt	CAV015	CAV024

GEFRAN spa

via Sebina, 74 25050 PROVAGLIO D'ISEO (BS) - ITALIA

ph. 0309888.1 - fax. 0309839063

Internet: <http://www.gefran.com>

**GEFRAN**

DTS\_MK4C\_1006\_ENG